



PHOTOGRAPHY: ERIC HAUSMAN

# antique chic

RECLAIMED BARN SIDING, BEAMS, OLD DOORS AND AN ANTIQUE PINE FLOOR SPICE UP A NEW ADDITION

## WISH LIST

- Larger kitchen
- Incorporate homeowner's antiques collection
- Big island that serves multiple roles

Despite the size of the house, the kitchen was small and dated, yet it worked well enough for a couple raising children. But instead of downsizing once the kids had grown and flown the nest, the owners decided now was the ideal time to put on an addition and build the kitchen of their dreams.

Because of the wife's well-honed eye (from buying antiques abroad for her Chicago shop, The Right Stuff at Vintage Pine), she took an active role in the kitchen's redesign, suggesting antique barn siding for the ceiling, an antique pine floor and old wood doors for the front of a hutch, which is fitted with glass to show off her finds. The wife also wanted a big island at the center, which designer Gail Drury of Drury Design created in a traditional style with an emphasis on function, her trademark. The island features a large farmhouse-style sink in the main cleanup zone; a big built-in wood chopping board close to the sink and a range top; a wine cooler on one side for the husband to mix drinks; and a Calcutta Gold marble top, which provides more work surface plus an area for four to eat comfortably, prep food or simply schmooze.

"Because we didn't want any seams to show, these two materials [wood and marble] work perfectly, and she wasn't afraid of the marble getting worn. In fact, she loves how it's gotten etched and gained a patina over time," Drury says. The rest of the equipment was divided among the room's legs but with plenty of counter space between: the large range, separate wall ovens, a big refrigerator-freezer behind armoire-style doors, a desk and a hutch—which has doors the wife found in France, then had cut down and painted to match the kitchen cabinets. Because Drury designed the room without a lot of upper cabinets, she tucked storage into a variety of spaces, including niches on each side of the refrigerator/freezer area. The maple kitchen cabinets were painted and glazed to fit the antique mood, which was inspired by the barn siding on the ceiling and the antique pine floor. A big chandelier and accessories add yet more style and panache.

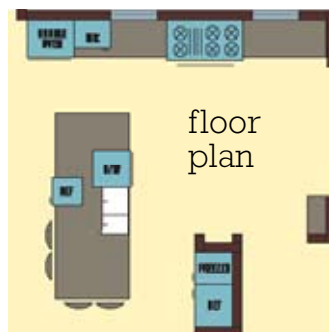

ABOVE: Antique pine floors, glazed cabinets and a marble countertop set an old-world feel in this kitchen.

ABOVE LEFT: A china hutch and farmhouse sink add to the mood.

**DESIGNER:**  
Gail Drury, CMKBD  
Drury Design  
512 N. Main St.  
Glen Ellyn, IL 60137  
630-469-4980  
drurydesigns.com

**LOCATION:** Hinsdale, IL

**DIMENSIONS:** 25' x 16'  
in most of the room

**>>> SPECIAL FEATURES:**  
Hutch on back wall made from doors found in France; Reclaimed barn ceiling paired with beams; Large marble island with butcher-block area

### PRODUCTS USED:

- **Cabinetry:** The Grabill Cabinet Co., maple, glazed and painted
- **Hardware:** Top Knobs
- **Countertops:** Calcutta Gold marble, honed finish, and butcher block on small area
- **Backsplash:** Calcutta Gold marble that matches countertops
- **Refrigerator/freezer:** Sub-Zero

- **Sinks:** Rohl
- **Faucets:** Newport Brass
- **Range:** Wolf
- **Microwave:** GE
- **Warming drawer:** Dacor
- **Wine cooler:** U-line
- **Dishwasher drawers:** Fisher & Paykel
- **Hood:** Wood, from Modern-Aire
- **Floor:** Antique pine